

Wi-Fi Environment Self-Checking

If you can't connect successfully, please set the Wi-Fi environment.

1. Check router bottom label, visit the IP address website and login.
2. Enable 2.4GHz at Wireless Settings, Select "WPA-PSK" or "WPA2-PSK" as Security Version and keep DHCP on.
3. Select "AES" or "TKIP" as Encryption type, DO NOT support "AES+TKIP".
4. DO NOT HIDE SSID.
5. Wi-Fi Password DO NOT include special symbol like #@\$%&*.....

(Step1)

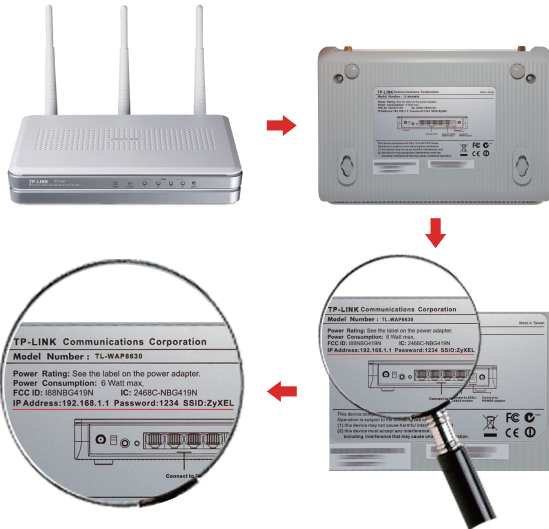

(Step2)

TP-LINK
TL-WPA8630

LED Logout Reboot

Wireless

2.4GHz: **Enable Wireless Radio**

Network Name (SSID): Hide SSID

Password:

Basic

Security: WPA/WPA2-Personal (Recommended)

Version: Auto **WPA-PSK** WPA2-PSK

Encryption: Auto TKIP **AES**

Mode: 802.11b/g/n mixed

Channel Width: Auto 20MHz 40MHz

Channel: Auto

Transmit Power: Low Middle High

TP-LINK
TL-WPA8630

LED Logout Reboot

DHCP Settings

DHCP Server: Disable **Enable**

Start IP Address: 192.168.2.100

End IP Address: 192.168.2.199

Lease Time: 120 minutes (1-2880 minutes, the default value is 120)

Default Gateway: 192.168.2.254 (optional)

Default Domain: (optional)

DNS Server: 192.168.2.254 (optional)

Secondary DNS Server: 0.0.0.0 (optional)

Save

- Status
- Quick Setup
- Network
- Dual Band Selection
- Wireless 2.4GHz
- Wireless 5GHz
- Guest Network
- DHCP**
- DHCP Settings
- DHCP Clients List
- Address Reservation
- USB Settings
- NAT
- Forwarding
- Security
- Parent Control
- Access Control
- Advanced Routing
- Bandwidth Control
- IP & MAC Binding
- Dynamic DNS